



TUSCOLA COUNTY DRAIN COMMISSIONER  
Robert Mantey  
125 W. Lincoln Street  
Caro, Michigan 48723

## FOREST INTERCOUNTY DRAIN

### NOTICE OF DAY OF REVIEW OF DRAINAGE DISTRICT BOUNDARIES AND REVIEW OF APPORTIONMENTS

**DATE:** Wednesday, August 1, 2018

**TIME:** 9:00 a.m. – 5:00 p.m.

**LOCATION:** Tuscola County Drain Commissioner's Office  
Purdy Building, Suite 100  
125 W. Lincoln Street  
Caro, Michigan 48723

**QUESTIONS:** (989) 672-3820  
Please leave a detailed voicemail. All calls are returned in the order received.

The Day of Review is an opportunity to review the Forest Intercounty Drain Drainage District boundaries and apportionment of benefit with the Drain Commissioner or a staff member. A map of the proposed Drainage District boundary revisions can be found on the reverse side of this notice and on the Drain Commissioner's website at: <https://www.tuscolacounty.org/drain/>.

The Drain Commissioner, engineers and/or other staff members will be available to assist individuals throughout the day, and make revisions where necessary. There is no need to schedule an appointment for a specific time on the Day of Review. The computation of costs for the Drain will also be available at the Day of Review. Drain assessments are collected in the same manner as property taxes and will appear on your winter tax bill. If drain assessments are being collected for more than one (1) year, you may pay the assessment in full with any interest to date at any time and avoid further interest charges.

Persons with disabilities needing accommodations for effective participation in the Day of Review should contact the Drain Commissioner's Office at the number noted above (voice) or through the Michigan Relay Center at 7-1-1 (TDD) at least 24 hours in advance of the Day of Review to request mobility, visual, hearing or other assistance.

You may appeal the Drain Commissioner's decision to revise the district boundary to the Tuscola County Circuit Court within ten (10) days, and you may also appeal the determination of apportionments to the Tuscola County Probate Court within (10) days.





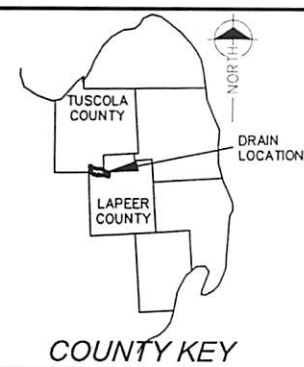
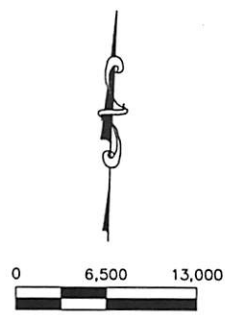
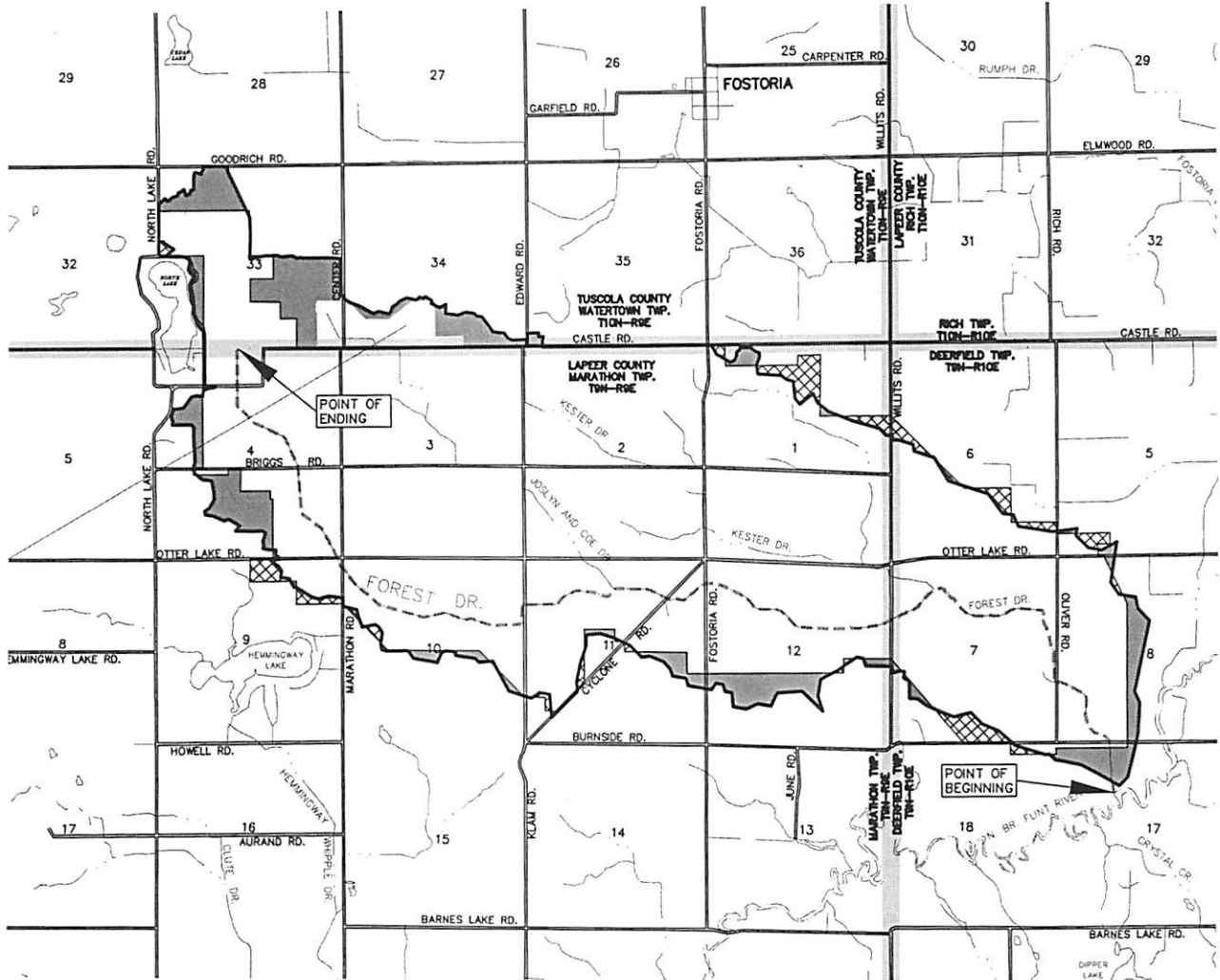

# FOREST INTERCOUNTY DRAIN

## LANDS ADDED AND REMOVED DRAINAGE DISTRICT

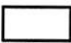
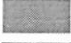
TUSCOLA AND LAPEER COUNTY DRAIN COMMISSIONERS  
ROBERT J. MANTEY AND JOSEPH SUMA



**LEGEND**

	DRAINAGE DISTRICT BOUNDARY
	LANDS ADDED
	LANDS REMOVED
	DRAIN
	MUNICIPAL BOUNDARIES
	COUNTY BOUNDARIES
	ROADS

# FAQs

Robert Mantey  
Tuscola County  
Drain Commissioner



## FREQUENTLY ASKED QUESTIONS about the Day of Review of Drainage District Boundaries and Review of Apportionments

### ***What is a Day of Review of District Boundaries?***

The Michigan Legislature passed a law in 2013 to allow revisions to historical drainage district boundaries when recommended by a licensed engineer.

Property owners can review changes with the Drain Office staff during the Day of Review. The proposed boundary revisions can be found on the map on the reverse side of the notice and in more detail at the Tuscola County website at: <https://www.tuscolacounty.org/drain/>.

### ***What is a Drainage District?***

A drainage district is the land area that benefits from the drain. The drainage district makes up the watershed that contributes water to the drain. Each property and municipality within the drainage district pays for maintenance and improvement of the drain.

### ***Why are the boundaries being revised?***

Revisions are recommended because the historic drainage district boundaries do not accurately reflect the current watershed of the drain.

### ***What is a Day of Review of Apportionments?***

A Day of Review of Apportionments provides an opportunity for property owners to review the percent of benefit of the drain assigned to their property. The apportionments of benefit are based on acreage, land use, and other factors. The apportionments determine the assessment amount for each property for costs of construction or maintenance.

### ***Why are the apportionments being revised?***

Parcel apportionments are being revised to more accurately reflect the percentage of benefit that each property receives from the drain.

If a parcel is on the outer boundary of a drainage

district, it is possible that only a portion of the parcel will be assessed.

### ***Why did I receive a notice?***

Notices went out to the following property owners:

- ***Properties being added to the Drainage District.*** The properties were not previously in the drainage district, but the engineers determined that the properties are within the drain's watershed.
- ***Properties being removed from the Drainage District.*** The properties were previously in the drainage district, but the engineers determined that the properties are not in the drain's watershed.
- ***Properties currently in the Drainage District and proposed to remain in the Drainage District.*** There is no change in terms of boundaries for these properties.

All property owners subject to an assessment were sent a copy of the notice.

### ***When do I receive my drain assessment?***

Drain assessments are included on your Winter Tax bill, and are only levied when costs are incurred for the drain. Assessment amounts vary from year to year.

### ***What is my assessment amount?***

Estimated assessment amounts will be available at the Day of Review.

### ***Do I have to attend the Day of Review?***

You are not required to attend the Day of Review.

### ***How can I get more information?***

Visit the Tuscola County website at <https://www.tuscolacounty.org/drain/> or call (989) 672-3820.

**Robert Mantey**

Tuscola County Drain Commissioner | 125 W. Lincoln Street | Caro, MI 48723 | (989) 672-3820